



FEATURES & SPECIFICATIONS

A small profile T5 HO fluorescent commercial/industrial luminaire robustly designed for maximum performance with minimum energy use in a broad range of applications from task lighting to general illumination. With near tool-less design the RAPTOR™ is ready to install right out of the box – even the lamps come pre-installed. Multi-volt ballasts take the guesswork out of what to stock. Rated at 93 L/W (54 watt lamp), this product offers outstanding savings on installation and maintenance labor costs. **UL/CUL Damp Location Listed. MADE IN USA.**

Housing

One-piece extruded aluminum housing with integral ballast heat-sink. Ballast/wiring compartment easily accessed for servicing. 16 gauge aluminum endplates with ½" wiring hole. Clear anodized standard finish – Anodized colors available.

Electrical

Ballasts are CBM certified HPF electronic programmed start, 0.99 power factor, <10% THD, UL/CSA listed, Type 1 Class P. Lamp holders are positive-lock, captive rotor type.

Optics

95% reflective specular hard-anodized aluminum roll-formed engineered T5 reflector. High DR extruded acrylic linear-prism lens with smooth exterior face for ease of cleaning. 10% uplight component.

Mounting

Fixture provided with Quick Clip™ stainless steel snap-on mounting brackets that accept #12 S-hook & chain or ¼" threaded rod; allows surface mounting without penetrating the fixture body. Other mounting options available.

Shipping

Shipped assembled & fully tested in Protective Job Pack.

Project	
Fixture Type	
Catalog #	
Distrib/Cont	
Date:	Prepared By:

RAPTOR™ Series

RAP1™

PATENT PENDING

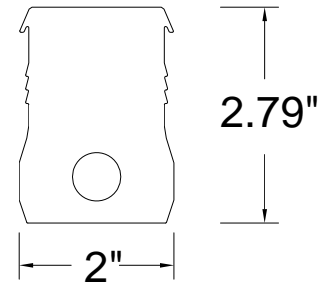

Dimensions

2"W x 2.79"H x 47.75"L

Weight : 4 lbs. 10 oz.

CATALOG NUMBER LOGIC:

--

FIXTURE MODEL	FIXTURE LENGTH	LAMP WATTS	LAMP COLOR TEMP.	BALLAST	OPTIONS
---------------	----------------	------------	------------------	---------	---------

BALLAST AND OPTIONS DESCRIPTIONS:

MODEL:

RAP1 = RAPTOR™ 1 LAMP PROFILE

LENGTH:

- 2 = 2 FEET NOMINAL (1 LAMP TOTAL)
- 3 = 3 FEET NOMINAL (1 LAMP TOTAL)
- 4 = 4 FEET NOMINAL (1 LAMP TOTAL)
- 5 = 5 FEET NOMINAL (1 LAMP TOTAL)
- 8 = 8 FEET NOMINAL (2 LAMP TOTAL)

LAMP WATTAGE:

- 24 = 2' (NOM.) 24W HO(2000 LUMENS)
- 39 = 3' (NOM.) 39W HO (3500 LUMENS)
- 54 = 4' & 8' (NOM.) 54W HO (5000 LUMENS)
- 28 = 4' & 8' (NOM.) 28W HE (2900 LUMENS)
- 80 = 5' (NOM.) 80W HO (7000 LUMENS)

COLOR TEMPERATURE (LAMP):

- 30 = 3000 K 50 = 5000 K
- 35 = 3500 K 65 = 6500 K
- 41 = 4100 K XX = NO LAMPS

BALLAST:

- MV = MULTI-VOLTAGE (120V to 277V, 50/60 Hz)
- D3 = DEDICATED 347V
- D4 = DEDICATED 480V
- DM = DIMMING BALLAST (Specify manufacturer & model)

MOUNTING:

* SPECIFY LENGTH OF DROP IN FEET

- ACC* = Aircraft cable suspension kit with bolt-on gripper (fits mtg. clips)
- ACP* = Powered aircraft cable kit, one circuit, bolt-on gripper (fits mtg. clips)
- ACPB* = Powered aircraft cable kit, two circuits, bolt-on gripper (fits mtg. clips)
- HD = Heavy Duty RAPTOR™ mounting brackets
- PFS1/3 = Power feed stem kit with ¾"NPT (PFS3) or ½"NPT (PFS1) coupling
- CR = Continuous row assembly (per fixture)
- WBADJ = RAPTOR™ Adjustable wall bracket mount
- SC = Safety Cable, adjustable Gripple #2, 10' length

OPTIONS:

*SPECIFY LENGTH OF DROP IN FEET

- CS* = CORDSET, 16/3, BLACK INSTALLED
- CT* = CORDSET, 16/4, BLACK INSTALLED
- FW* = FLEX WHIP, 3/8" 18/3 FILL, ½" FITTING
- OS = OCCUPANCY SENSOR, FIXTURE MOUNTED (SPECIFY DISTRIBUTION)
- PC = PHOTOCELL, FIXTURE MOUNTED (SHIPS INSTALLED)
- HM = FIXTURE TOP POWER ENTRY HOLE (SPECIFY LOCATION ON FIXTURE)
- GLR = GLR IN-LINE FUSING - INSTALLED (SPECIFY VOLTAGE AND AMPERATE)
- EM = EMERGENCY BATTERY BALLAST
- EMT = EMERGENCY BATTERY BALLAST, SELF-TESTING



RAPTOR™ Series

RAP1™

PHOTOMETRIC TEST REPORT:

REPORT NUMBER: ITL52934
 CATALOG NO.: RAP1-4-54-35-MV-XX
 TOTAL INPUT WATTS: 56.9
 FIXTURE EFFICIENCY: AT 5000 LUMENS – 67.8%
 AT 4450 LUMENS – 72.9%

DISTRIBUTION CURVE

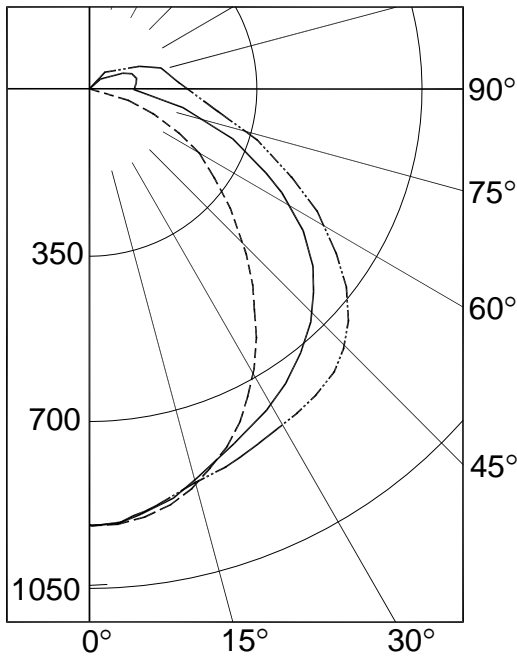

LEGEND 0-deg: - - - - -
 45-deg: _____
 90-deg: - · - · - · -

CANDELA DISTRIBUTION

	0.0	22.5	45.0	67.5	90.0
0	963	963	963	963	963
5	957	956	952	951	950
15	900	896	891	893	896
25	788	800	825	856	867
35	636	689	767	819	840
45	473	580	693	769	791
55	329	452	583	654	673
65	203	300	426	493	512
75	93	161	267	332	359
85	17	62	140	216	247
90	0	37	103	180	211
95	0	33	96	166	192
105	0	32	103	155	170
115	0	32	92	121	128
125	0	22	62	83	89
135	0	13	40	58	63
145	0	8	25	40	44
155	0	3	10	19	24
165	0	0	2	6	8
175	0	0	0	0	0
180	0	0	0	0	0

LUMINANCE DATA (CD/SQ. M)

	0-DEG	45-DEG	90-DEG
45	10894	13778	14575
55	9341	13210	13809
65	7822	11631	12272
75	5852	9534	10737
85	3177	7553	10234

ZONAL LUMEN SUMMARY (@ 5000 LUMENS PER LAMP)

ZONE	LUM.	%LAMP	%FIXT
0 - 30	725	14.5	21.4
0 - 40	1197	23.9	35.3
0 - 60	2203	44.1	65.0
0 - 90	3008	60.2	88.8
90 - 120	283	5.7	8.4
90 - 130	331	6.6	9.8
90 - 150	374	7.5	11.0
90 - 180	380	7.6	11.2
0 - 180	3388	67.8	100.0



ARRA
Funding Compliant

COEFFICIENTS OF UTILIZATION ZONAL CAVITY METHOD

RF	20	20	20	20	20	20
RC	80	70	50	30	10	0
RW	70 50 30 10	70 50 30 10	50 30 10	50 30 10	50 30 10	0
0	79 79 79 79	76 76 76 76	71 71 71	66 66 66	62 62 62	60
1	71 67 64 61	68 65 62 59	61 58 56	57 55 53	53 52 50	48
2	64 58 53 49	62 56 52 48	53 49 46	49 46 43	46 44 41	39
3	58 51 45 40	56 49 44 39	46 41 38	43 39 36	40 37 35	33
4	53 45 39 34	51 43 38 33	41 36 32	38 34 31	36 32 29	28
5	49 40 34 29	47 39 33 28	36 31 27	34 30 26	32 28 25	24
6	45 36 29 25	43 35 29 25	33 28 24	31 26 23	29 25 22	21
7	42 32 26 22	40 31 26 22	30 25 21	28 24 20	26 23 20	18
8	39 29 24 19	37 29 23 19	27 22 19	26 21 18	24 20 18	16
9	36 27 21 17	35 26 21 17	25 20 17	24 19 16	22 19 16	14
10	34 25 19 16	33 24 19 16	23 18 15	22 18 15	21 17 14	13

WARRANTY: The Light Edge, Inc. warrants the RAPTOR™ to be free from defects in material and workmanship for 15 years from date of purchase, exclusive of lamps, ballasts, and optional electrical devices. Refer to website for complete warranty information.